

BLOOM

Stop Bedwetting in Children For
Ages 5+

onestopbedwetting.com/bloom



SCAN FOR SUPPORT

WHAT'S INCLUDED

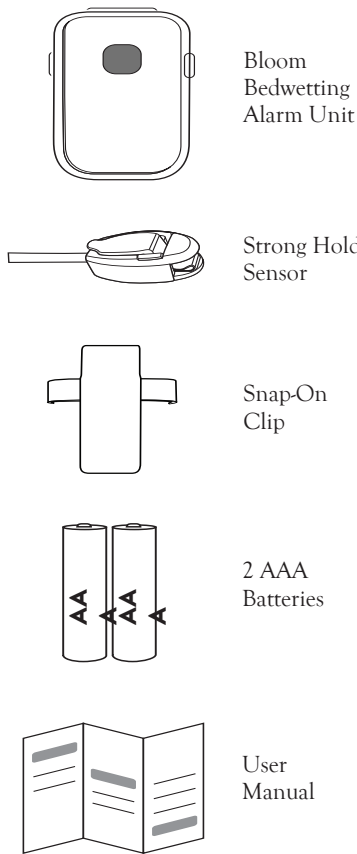

1. DESCRIPTION

Bloom bedwetting alarm is designed to stop bedwetting in children ages 5+.

Bloom bedwetting alarm is a complete treatment system with 8 unique and loud alert tones, vibration control and bright light. The alarm unit automatically cycles through different alert tones so your child doesn't get accustomed to any one tone.

Bloom alarm uses a moisture sensitive sensor to detect urine when your child wets the bed at night and triggers the alarm to wake up your child.

Bloom helps your child recognize the need to empty the bladder during sleep. With each bedwetting event your child becomes conditioned to wake up more quickly, and gradually learns to wake up before wetting the bed and staying dry.

The treatment must continue until at least 14 consecutive dry nights have been recorded.

A successful treatment may take a few months and requires parental support, commitment and positive reinforcement.

2. INITIAL SETUP

Note: Closing the sensor (lowering the lever) without attaching it to dry cloth will cause the alarm to sound.

Your Bloom alarm comes with 2 AAA batteries. Follow the step below.

- Release the clip from side of alarm unit.
- Open the battery door by sliding it towards the bottom of the alarm unit.
- Insert two AAA batteries (included) with polarities as shown in the image below. The alarm unit beeps, vibrates and flashes a light signaling batteries have been installed correctly.
- Close the battery door by gently sliding the battery door upward.
- Reinstall the snap-on clip.

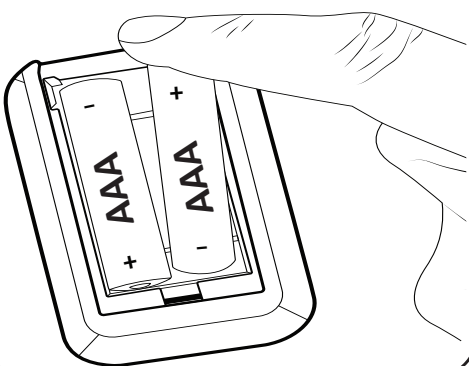

3. PROGRAMING BLOOM

Bloom bedwetting alarm can be setup with the easy program button.

The program button allows you to choose from 3 different settings. To make a selection, disconnect sensor from alarm unit. Every time a selection is made the alarm beeps and flashes a light.

- **Sound mode:** Press and release the program switch once.
- **Vibrate mode:** Press and release the program switch second time.
- **Sound & Vibrate mode:** Press and release the program switch third time.

Bloom is now setup and ready to monitor bedwetting events.

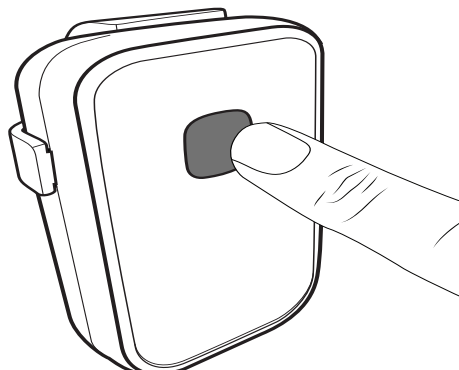

4. ATTACHING THE SENSOR

Bloom uses a comfortable clip sensor to detect urine. The sensor must be attached to the outside of your child's underwear as close as possible to the point of urination. For best results 100% cotton briefs are recommended. Follow the steps below to attach sensor to your child's underwear.

- Open the sensor by lifting the lever.
- Fold the cloth near the point of urination.
- Insert the folded cloth into the open sensor.
 - Secure the sensor on the underwear by releasing the lever.
 - Pull gently to test.

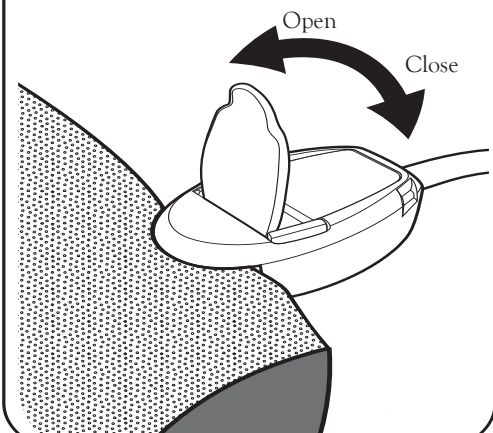

5. CONNECTING ALARM

CbW h Y g b g f l g g W f m U H W X l c m i f W j X g i b X f k Y f

i F i b h Y g b g f W f X i b X f m i f W j X g g j f h

i 7 c b b W h Y W f X l c h Y U f a i b j h V n j b g f h b h Y g b g f d i [] b l c h Y g b g f U W c Z h Y U f a i b j h

i 7 j d h Y U f a i b j h c b l c W j X g g j f h

U c j h X h Y b W j Y c f U c j b X U f a k j h h Y c d h c b U f a V b X U W g g f m

6 c c a k j b c k U y f h m i f W j X h Y a c a Y b h V X k Y h b c W W f g

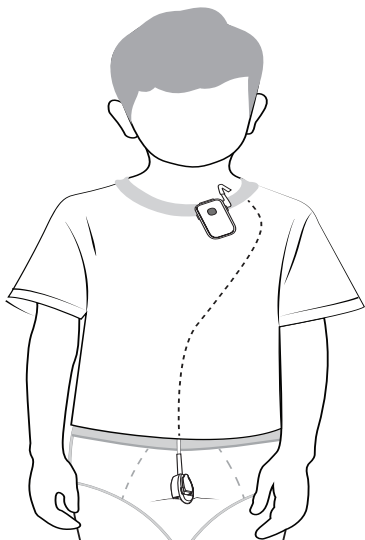

6. SHUTTING THE ALARM

5 U f a i b j h X c Y b h U j Y c b # Z Z g k j W h i l g Y g b h U l c Z c k h Y h c l g h d f c W g V y c k l c W a d Y h n g i h c Z Z h U W j Y U f a

i D F y g h Y d f c f U a V i h e b c b W l c h a d c f U j n h i f b c Z Z h Y U f a

i I b d i h Y g b g f Z c a h Y U f a i b j h c W a d Y h n g i h c Z Z h Y U W j Y U f a

Bloom alarm k j g e d W y d j b z j M U h b U b X Z g h b j l l g

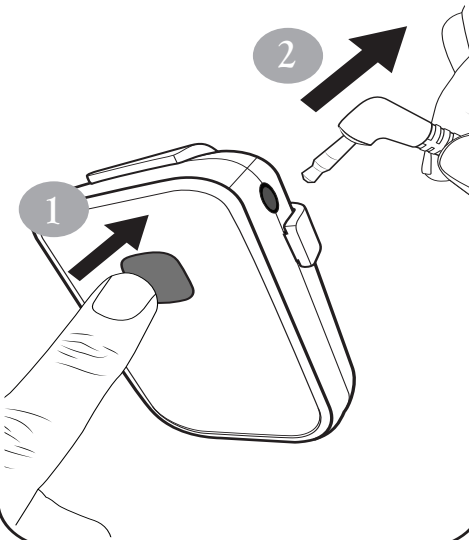

7. MAINTAINENCE

Cleaning the Alarm Unit

i H Y U f a i b j h l g b c h k U m f d f c c Z Y d j h X n i U h U h a Y g

i 7 Y b h Y U f a i b j h k j h U g c Z i X m i W e h U M f U W V X k Y h b j Y b h

i 8 c b c h c d f U h w j h k Y h U b X g

Daily Sensor Cleaning

: c k g h d g V y c k Z f W u b j h Y g b g f X U n i Z h f U W X k Y h b j U W X b h

i 8 l g b b Y W g b g f Z c a U f a i b j h

i @ Z h Y Y f l c c d y b h Y g b g f U b X j Y b h m f Y a c j Y j h Z c a h Y i b X f k Y f

i E j b g y i b X f H d k U m f c f 5 g W b X g

i K j h Y Y f c d y b z g U Y g b g f l c f Y a c j Y Y W g k U m f

i ; Y b h n k j d Y j b g X Y c Z g b g f k j h U b U g c f V b h W e h l c Y b g f Y h U h Y g b g f l g W a d Y h n g i h c Z Z h Y U W j Y U f a

Note: If the sensor is not completely dry, the alarm will sound.

Weekly Sensor Cleaning

: c k g h d g U c j Y I g y c U t n k U m f U b X j Y b h m g M V j b g X Y c Z g b g f k j h j b W X X V i g l c f Y a c j Y i f j Y f Y g X Y

Long Term Storage

8 l g b b Y W g b g f Z c a U f a i b j h Z f Y a c j Y U h m f Y g U b X g c f Y j b V e l

8. WARNINGS

H Y 6 c c a U f a l g b c h U l c m Y d j h U k U m Z c a g a U W j X f Y b

H Y c i X U y f h l c b y g a U n g U h Y m i f W j X k Y b U k U Y b W X U Y d f W m h c b

5 k U g f i b h Y g b g f W f X Y c k h Y g j f h i l g f Y W a a Y b X X l c i g Y U b Y k g b g f Z c f U W W j X l c V Y h Y U X X

8 l g b b Y W h Y g b g f Z c a h Y U f a i b j h c g Y W c d Y f U j c b a c X Y

8 c b c h i g Y W g j Y Z f W c b h Y W d U g j h a U n X l a U Y h Y g b g f

8 c b h i d i c b h Y g b g f W f X l c f Y a c j Y g b g f Z c a i b X f k Y f z U k U g i b X c W d l c f Y a c j Y g b g f

5 k U g i g Y Z g V u h m f Y g 8 c b c h a j l c X U b X b Y k V u h m f Y g

5 U f a l g b c h k U m f d f c c Z 8 c b c h j Y i U f a i b j h k Y i U h U n i h a Y

9 l h b X V u h m j Z V m X g b b Y W j b j g b g f U b X U f a i b j h k Y b c h j b i g

7 U h c b z g a U d l f g B c h Z f i g Y m W j X f Y i b X f m i f g c Z U Y

9. SUPPORT

H Y c g A Y X W G r h a g k U f U b l g h Y 6 c c a U f a i b j h Z f U d y l c X c Z c b Y f l e m U f U b X h Y g b g f Z f U d y l c X c Z h f Y f l E a c b h g U j b g h X Z W g j b a U m f U U b X k c f a U b g j d i b X f b c f a U i g Y Z c a h Y X U h c Z d i f W U g H j g k U f U b m j g b c b l f U b g Z f U V Y U b X X c Y g b c h W j Y a l g g Z U m g y c f X l a U Y Z c a b Y j j Y b W : c f W g r a Y g d d c f h U b X c f l c d i f W U g Y U W g f j g v b h U W



THEOS MEDICAL SYSTEMS



Theos Medical Systems, Inc. &) (G h i 6 j X G b u H 7 U L Z 7 5 -) (1 G 5

Tel: f i S, E & - ! (S) S
Toll free: f i S S E & S * + +) f i G 5 E
g d d c f h 4 c b y g r e d b e d w e t t i n g . c o m
o n e s t o p e d b e d w e t t i n g . c o m / b l o o m



SCAN FOR SUPPORT

10. REGULATORY

Bloom bedwetting alarm exceeds many performance, construction and safety requirements. Alarm unit is battery powered and double insulated for added protection. Leakage current across the sensor is less than required for medical surgical devices: less than 8µA in any condition; less than 1µA when sensor is wet. Bloom, Strong Hold, Wake Up Dry Feel Confident and Bloom and Theos Medical Systems logos are trademarks or registered trademarks of Theos Medical Systems, Inc.



PPN/Ref.: TBL1W
Doc.: TBL1W-MN-EN-1
Rev. date: 08/24

Designed in USA.
Manufactured in China.

The user manual must be retained since it contains important information.

© 2024 Theos Medical Systems, Inc. All Rights Reserved.